

Rates

Conference Center

CONFERENCE ROOM A

AV flat fee - \$100 Flat rate	Tenant	Non-Tenant
Regular Rate Weekday 7:00 AM - 5:00 PM	\$62.50/hour	\$93.75/hour
Evening Rate 5:00 PM - 9:00 PM or any fraction thereof	\$410	\$535
Weekend Rate 1/2 Day (8 AM-12 PM or 1 PM-5 PM) Full Day (8:00 AM - 5:00 PM)	\$410 \$750	\$535 \$1,000

CONFERENCE ROOM C

AV flat fee - \$100 Flat rate	Tenant	Non-Tenant
Regular Rate Weekday 7:00 AM - 5:00 PM	\$52.50/hour	N/A

FULL CONFERENCE CENTER (A, B, C AND PRE-FUNCTION)

AV flat fee - \$300 Flat rate	Tenant	Non-Tenant
Weekday (Monday – Friday) Weekday 7:00 AM - 5:00 PM	\$215/hour	\$287.50/hour
Evening Rate 5:00 PM - 9:00 PM or any fraction thereof	\$1,200	\$1,600
Weekend Rate 1/2 Day (8 AM-12 PM or 1 PM-5 PM) Full Day (8:00 AM - 5:00 PM)	\$1,200 \$2,400	\$1,600 \$3,200

CONFERENCE ROOM B

AV flat fee - \$200 Flat rate	Tenant	Non-Tenant
Regular Rate Weekday 7:00 AM - 5:00 PM	\$72.50/hour	\$107.50/hour
Evening Rate 5:00 PM - 9:00 PM or any fraction thereof	\$470	\$615
Weekend Rate 1/2 Day (8 AM-12 PM or 1 PM-5 PM) Full Day (8:00 AM - 5:00 PM)	\$470 \$860	\$615 \$1,150

CONFERENCE ROOM A & B

AV flat fee - \$300 Flat rate	Tenant	Non-Tenant
Regular Rate Weekday 7:00 AM - 5:00 PM	\$143.75/hour	\$215/hour
Evening Rate 5:00 PM - 9:00 PM or any fraction thereof	\$800	\$1,200
Weekend Rate 1/2 Day (8 AM-12 PM or 1 PM-5 PM) Full Day (8:00 AM - 5:00 PM)	\$800 \$1,600	\$1,200 \$2,400

7TH FLOOR CONFERENCE ROOM – 1616 P ST.

No AV fee	Tenant & Non-Tenant
Weekday (Monday – Friday) Weekday 8:00 AM - 5:00 PM	\$125/hour
After hours, Weekend & Holidays	\$165/hour

Up to 64 People Conference Room B

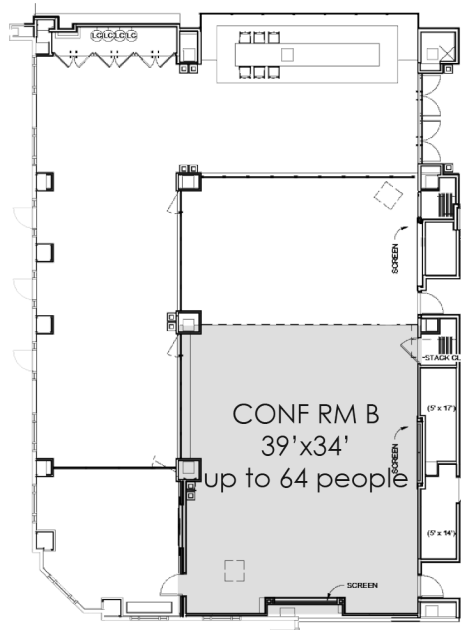

C Shaped
22 People

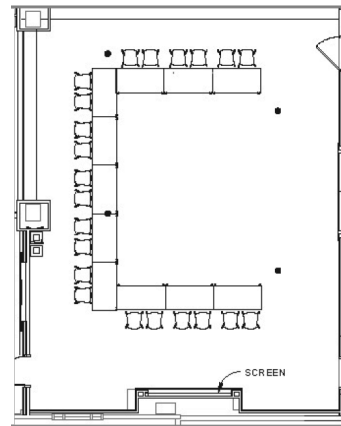

Classroom
40 People

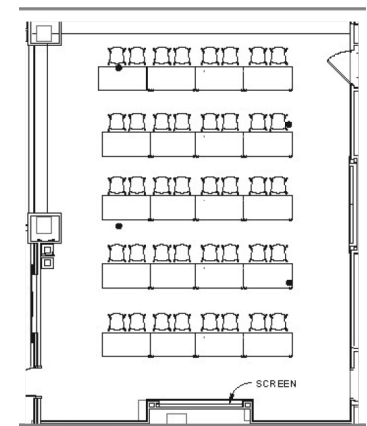

Hollow Square
32 People

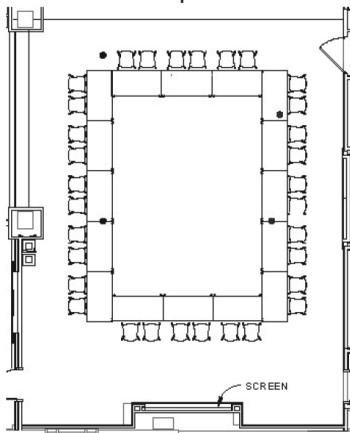

Theatre
64 People

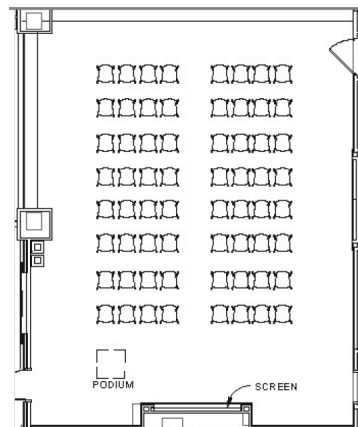

U Shaped
30 People

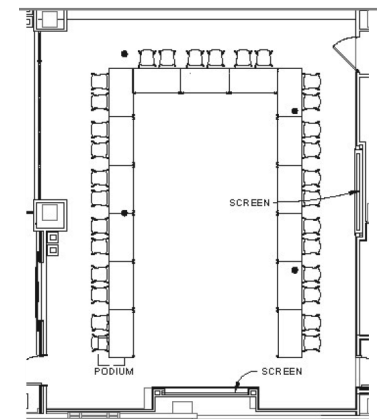

Up to 10 People Conference Room C

CONF RM C
19'x13'
up to 8 people

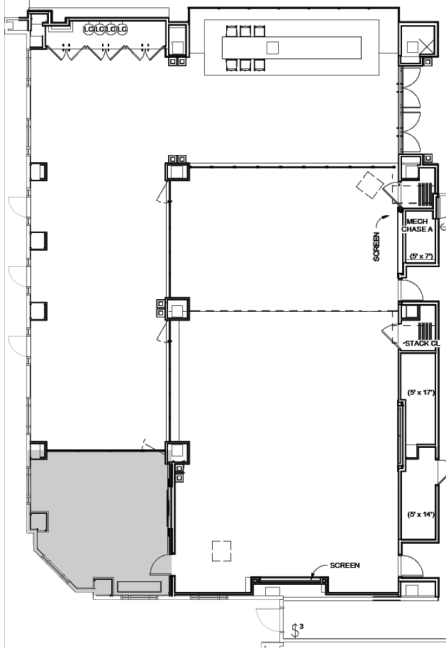

Standard
8 People

C Shaped
10 People

Classroom
8 People

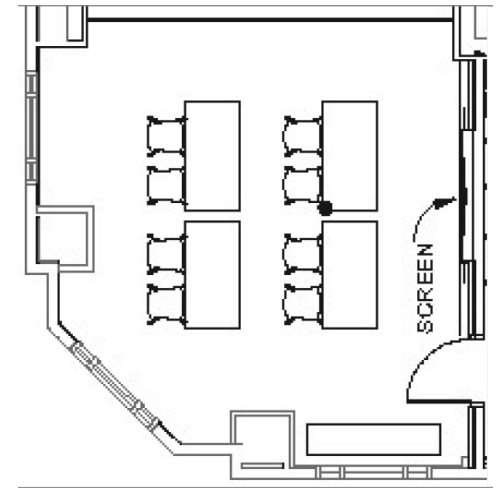
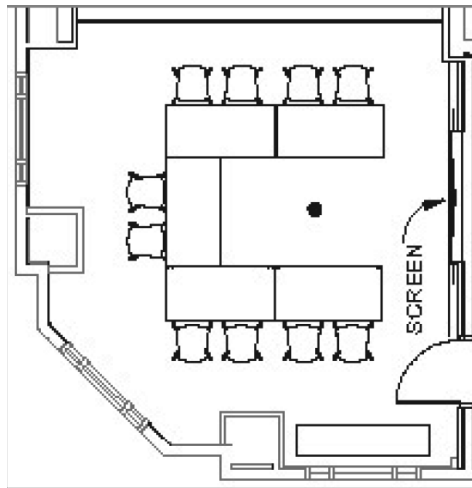
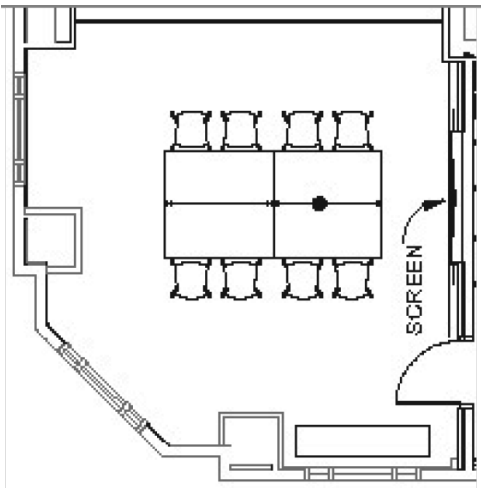

Up to 104 People Conference Room A & B

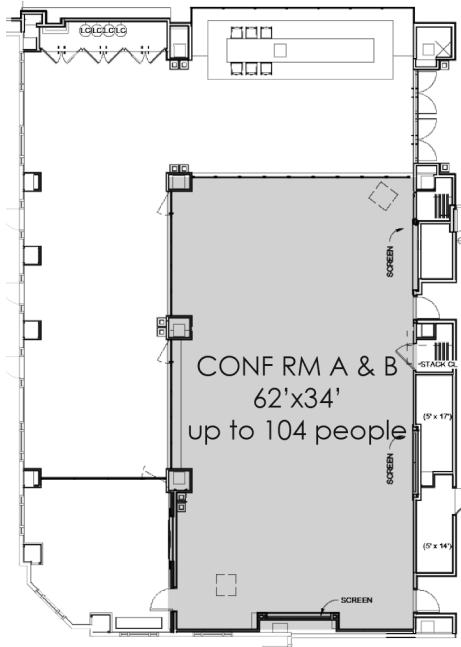

C Shaped
30 People

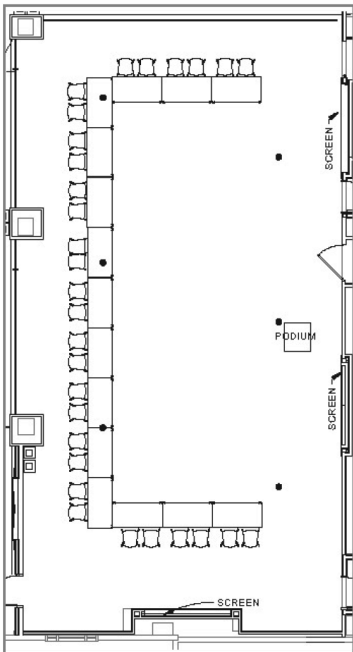

Classroom
64 People

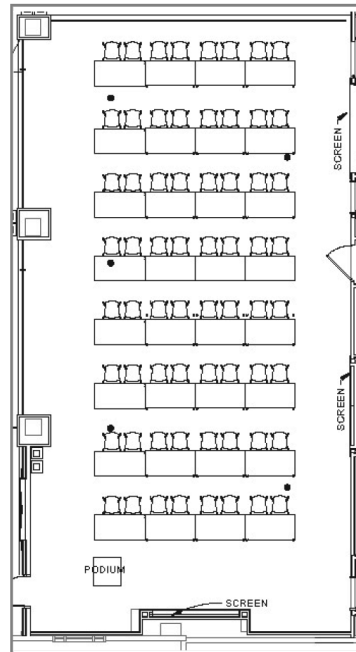

Hollow Square
52 People

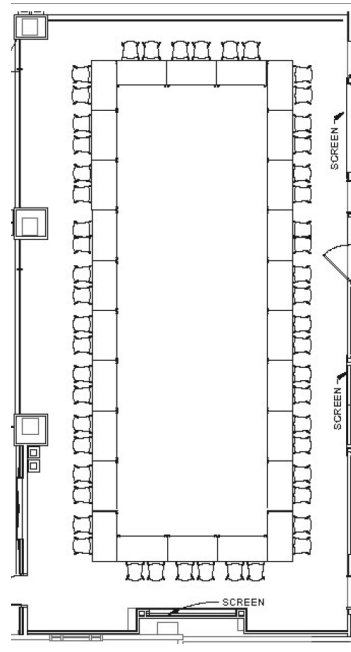

Theatre
104 People

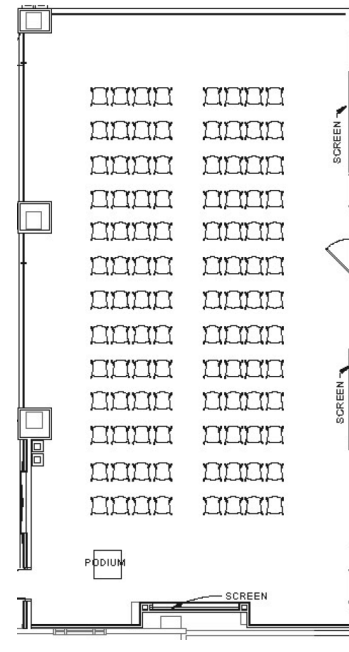

U Shaped
38 People

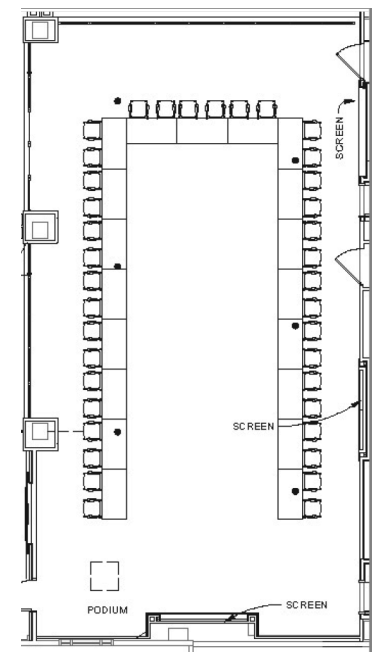

Up to 145 People Full Conference Center

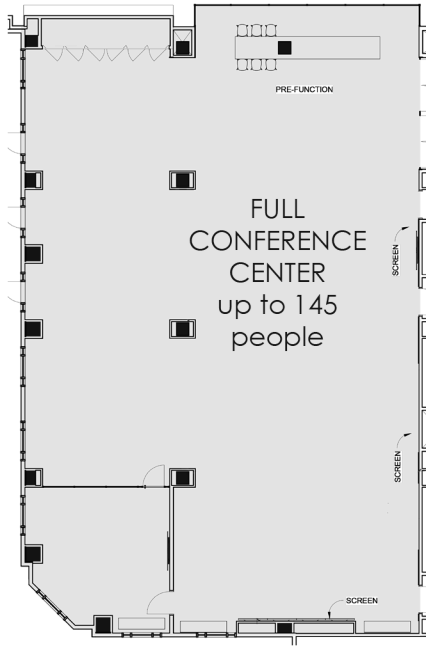

Theatre
144 People

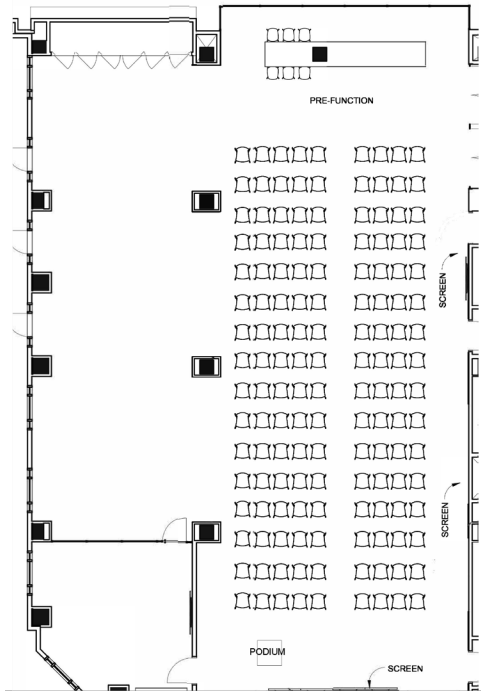

Dual Screen Theatre
145 People

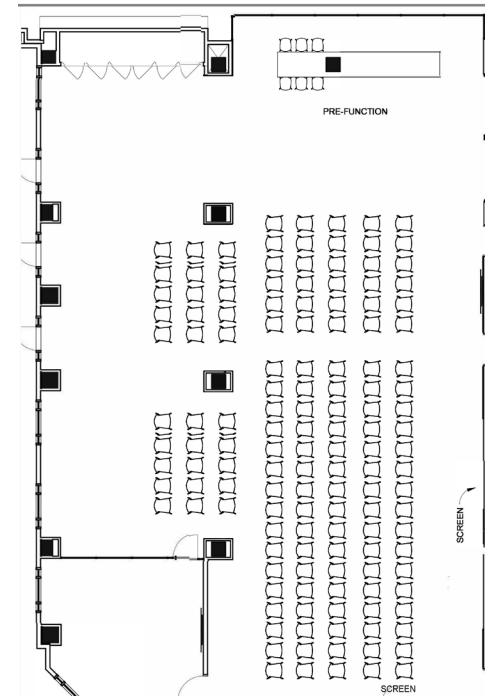

Up to 40 People

7th Floor Conference Room

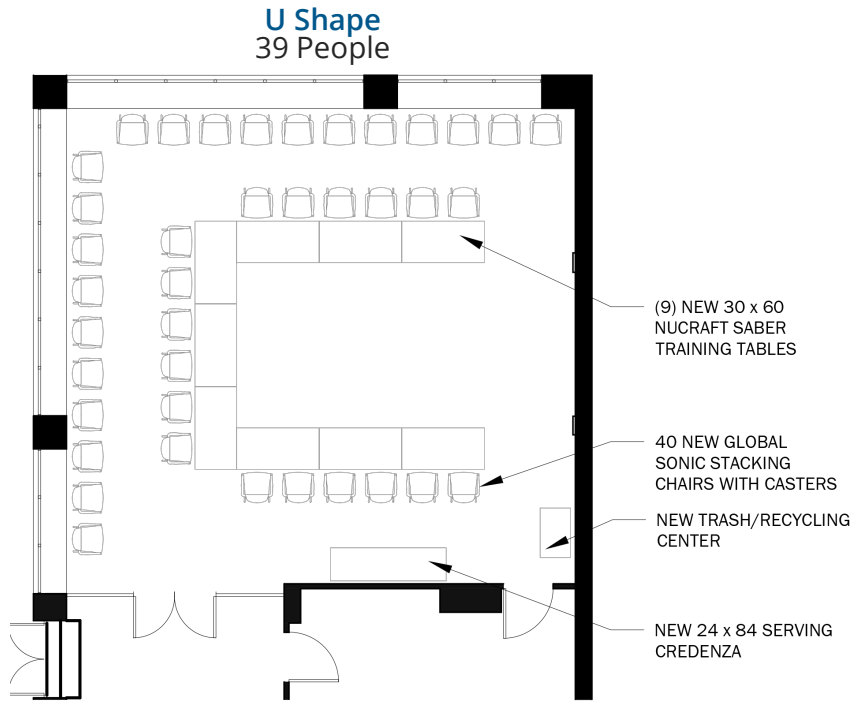

Training Layout
34 People

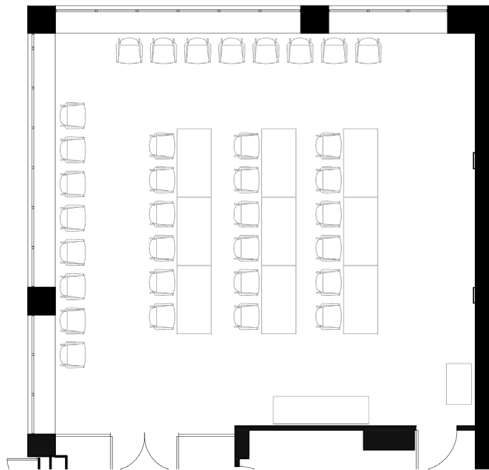

Theatre
40 People

